

Railings:  
 1-1/2" square tubing painted gloss black.  
 Wrought Iron or Pipe rail styles also available  
 as well as custom made to your design.

### Elevation

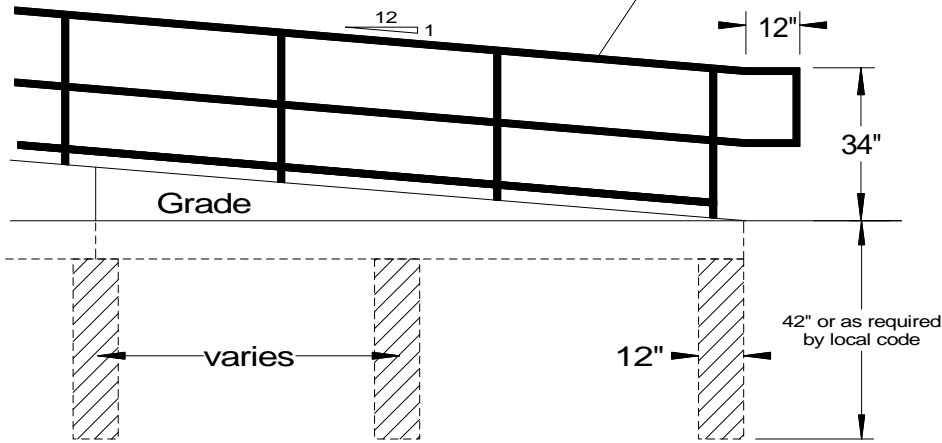

1" square guardrail added where ramp is 30" or higher above adjacent surface.

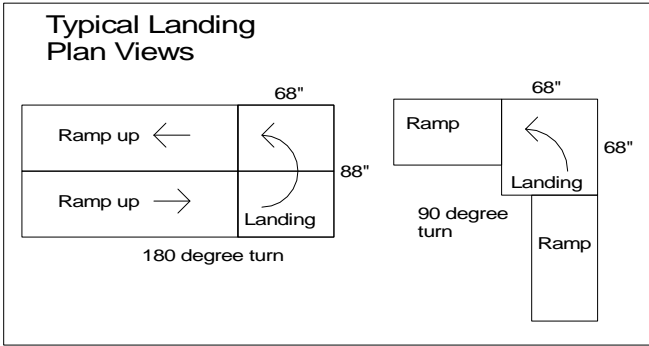

### Typical Ramp Section

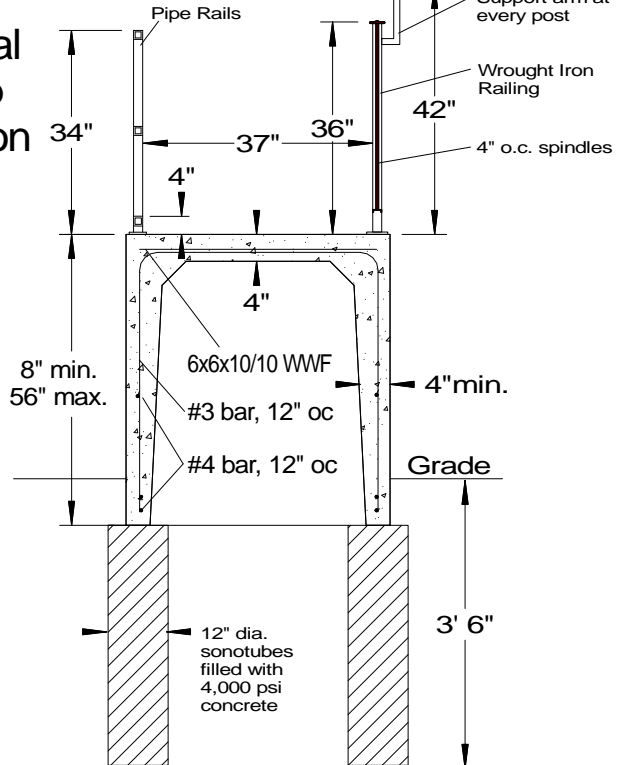

### Design Guidelines:

1. Ramp lengths up to 16' per section.
2. Ramps are preformed to a 1:12 pitch.
3. 30' length maximum allowable between landings.
4. Any ramp surface more than 30" higher than an adjacent surface must use a 42" high guardrail as shown on typical ramp section on right.
5. Landings at doors will vary depending on door swing and approach.
6. Custom landings and steps can be made to match your requirements.
7. Wider ramps are possible with custom made pieces.

SPECIFICATIONS	
Concrete Min. Strength: 4,000 psi at 28 days Reinforcement: #3 Rebar, 6x6x10ga WWM Air Entrainment: 5% Construction Joint: Sikaflex 1a Polyurethane Finish: Broomed & edged surface Load Rating: 300 psf	<p><b>PRECAST ACCESS RAMPS HANDI-RAMP SYSTEM</b></p> <p><b>Woodard's Concrete Products, Inc.</b>          629 Lybolt Road, Bullville, NY 10915          (845) 361-3471 / Fax 361-1050</p>
Page 4E 2/1/05	