

Base Vault

Top View

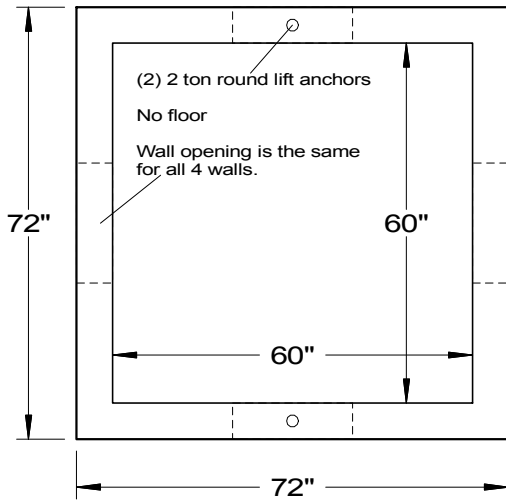

Side View

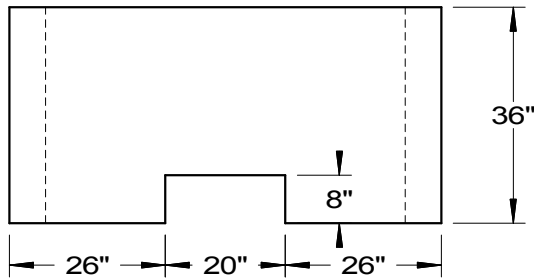

Concrete = 1.2 yards
Weight = 4,800 lbs
SS# 262-722-00

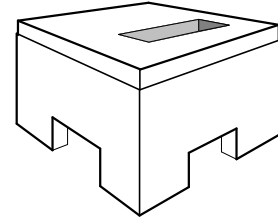

Top View of Pad

Smooth trowel finish with large radius edge around outside.

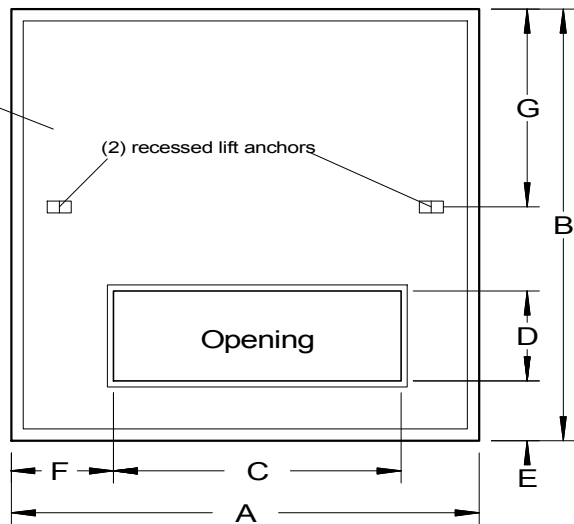

Flatpads

For Padmounted Utilization and Step Transformers

Side View

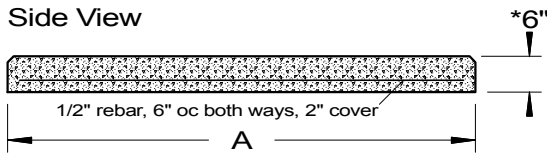

*Used for conversion of a submersible transformer installation to a padmount installation. This unit is 4" thick.

Type	Transformer Rating			Dimensions in inches							Weight	SS#
	KV	Phase	KVA	A	B	C	D	E	F	G		
Util.	15/35	1	25-167*	50	50	24	12	7	13	24	750 lb	262-803-00
Util.	15	3	75-500	72	72	40	16	12	16	34	2300	262-776-00
Util.	15	3	750-2500	89	75	50	17	14	21	35	3000	262-781-00
Util.	35	3	75-1500	89	75	50	17	14	21	35	3000	262-781-00
Util.	35	3	2500	96	96	60	24	12	24	43.5	4300	262-782-00
Step		1/3	250-500	76	71	30	15	22.5	23	35	2600	262-790-00
Step		3	500-1500	95	89	43	17	20	26	43	4100	262-791-00
Step		3	1500-2500	96	96	62	17	20	17	45.5	4300	262-792-00
Step		3	3750-5000	120	120	80	24	20	20	56	6500	262-793-00

SPECIFICATIONS

Concrete Min. Strength: 4,000 psi at 28 days
Reinforcement: #4 Rebar / ASTM A615
Air Entrainment: 6%
Construction Joint: Butyl Rubber Sealant

TRANSFORMER VAULT & PADS NYSEG

Woodard's Concrete Products, Inc.
629 Lybolt Road, Bullville, NY 10915
(845) 361-3471 / Fax 361-1050

6/28/2018